



BAG PRINTERS

Printing bags in house as needed has many benefits for the cost and quality-conscious plant...

■ It can generate savings of up to 70% in your pre-printed bag inventory, both in dollars and in valuable floor space.

■ It improves scheduling because it allows "Just-in-Time" printing of variable information on bags.

■ It produces high quality imprints for bar codes and

ingredient statements, logos and other variable information.

■ It eliminates the high cost of manually-applied labels or hand stenciling.

MODEL 2712 MANUAL FEED BAG PRINTER

Prints anywhere on the bag at speeds to 30 bags/minute



The Kiwi Model 2712 Flat Bag Printer can be used to imprint multi-wall paper bags, polyethylene bags and rigid sheets with any desired variable copy. Information such as part numbers, bar codes, product descriptions, ingredient statements, etc., can be applied at speeds up to 30 bags/minute, depending only on the rate at which the operator feeds bags into the printer.

Imprints can be positioned anywhere on the bag, and the printer's flexographic inking system and optional recirculating ink pump permit use of fast drying inks. The Model 2712 incorporates a hand-loaded bag magazine and features a print-on-demand, no bag-no print system. Ink rollers run continuously; the clutch operated printing cylinder is triggered by an electric eye.

Select from magnetic, flexback or magflex printing cylinders.

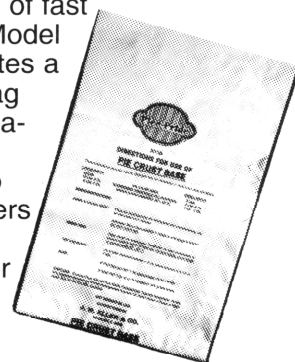

SPECIFICATIONS

Capacity	Bag/Sheet Size		Maximum Imprint Area	
	Width	Running Length	Width	Length
Min.	6"	16"	26"	20"
Max.	27"	46"		

Notes: Standard model includes feed table and catcher. Optional Model 3712 will accommodate widths to 37". Consult factory for sizes outside of this range.

PRODUCTION RATE:

Approx. 30 bags/min., hand feed

PRINTING CYLINDER:

40" circ. x 27" wide; Magnetic, Flexback or Magflex; Single revolution, Clutch Driven

POWER REQUIREMENTS:

230 Volt, 50/60 Hz. Single Phase

MOTOR:

1 HP, totally enclosed, variable speed drive

TYPE SYSTEMS:

Kiwi Channelok Type, Baselock Type, Magnetic Backed Printing Dies, Printing Mats

INKING SYSTEM:

Two roller flexographic, continuous run ink rollers. Kiwi #3 Ink and #8 Ink Conditioner/Cleaner are recommended for absorbent surfaces. Kiwi Flexo Inks recommended for polyethylene bag printing

FINISH:

Kiwi Blue

DISCHARGE HEIGHT:

42"

FLOOR SPACE REQUIRED:

55" Wide x 60" Long

SHIPPING WEIGHT:

1850 lbs. (840 kg)

OPTIONAL ACCESSORIES:

Recirculating Ink Pump • Totaling Counter • Predetermining Counter • Shingling Conveyor • Automatic Feed System



FLAT BAG

MODEL 2712 AUTOMATIC FEED BAG PRINTER

The Kiwi Model VF Vacuum Feeder System has been designed to feed flat paper and poly bags. Vacuum cups pick bags from the top of the stack and feed them into the Model 2712 Bag Printer. Maximum feed rate is 30 bags per minute.

An integral belt conveyor magazine automatically supplies bags to the vacuum feeder offering uninterrupted production. The micro-processor controlled flat belt conveyor magazine accommodates three to four stacks of bags, approximately 8" (203mm) high.

The number of stacks is determined by the bag width allowing approximately 1" between stacks. An optional, longer magazine is available.

After the first bag stack is emptied of bags, the conveyor moves the next full stack to the vacuum feed station where the feed sequence continues.

SPECIFICATIONS:

Capacity	Bag/Sheet size	
	Width	Running Length
Min.	①10" (254mm)	16" (406mm)
Max.	27" (686mm)	40" (1016mm)

NOTE①:

Consult factory for narrower width bags.

PRODUCTION RATE:

Up to 30 bags per minute.

INPUT POWER REQUIRED:

230 Volt, 50/60 HZ, single phase.

ELECTRIC CONTROLS:

NEMA Type 1.

FLOOR SPACE REQUIRED:

110" (43.3cm) x 80" (31.5cm).

MOTORS

Model 2712: 1HP, T.E., Variable speed drive.

CONVEYOR:

1/3 HP, 230V.

VACUUM PUMP:

3/4 HP, 230 V.

SHIPPING WEIGHT:

2700 lbs. (1227 kg)

PRINTERS

MODEL UC MANUAL FEED BAG PRINTER

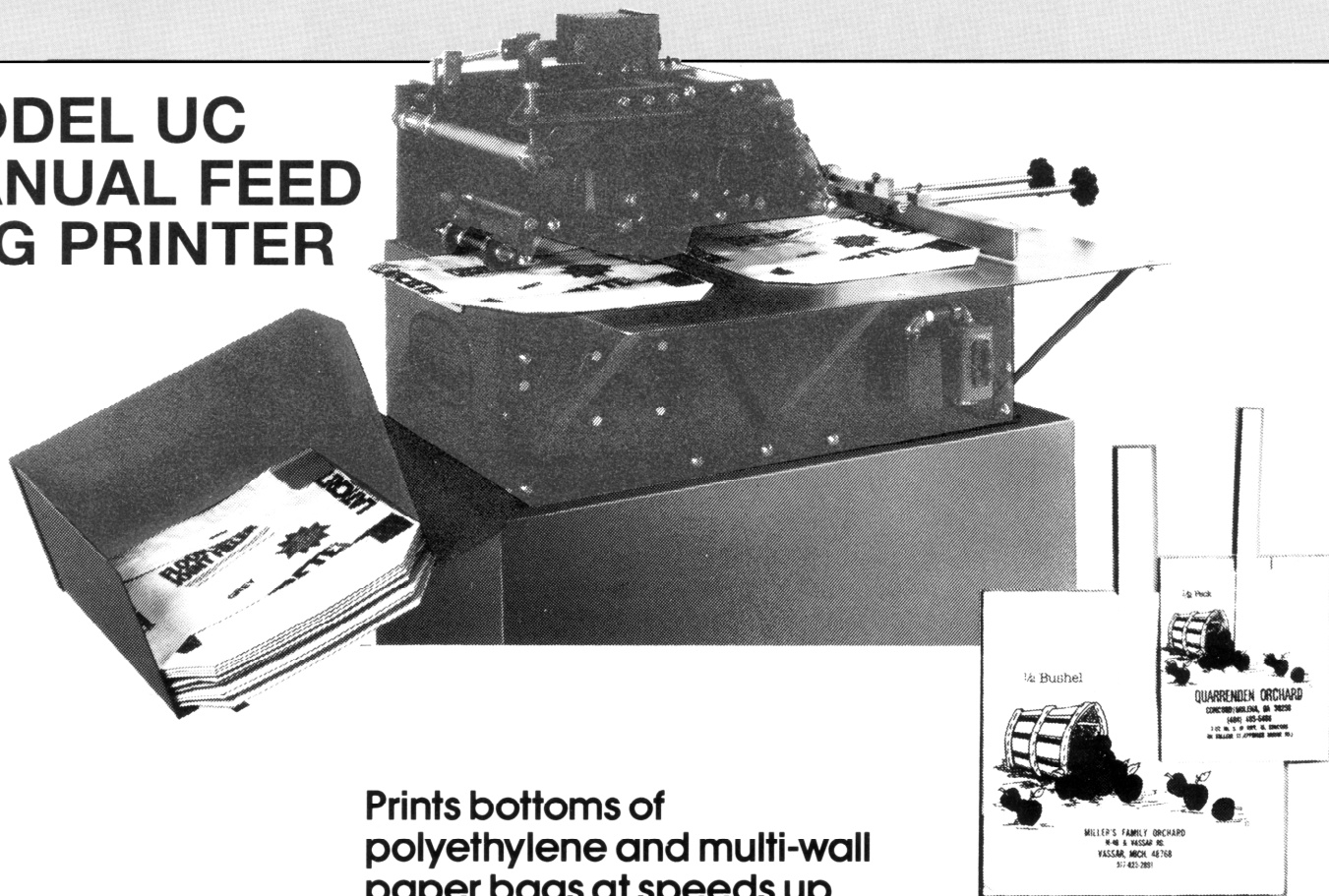

**Prints bottoms of
polyethylene and multi-wall
paper bags at speeds up
to 30 bags/minute**

Here's a quick, easy method for imprinting polyethylene and paper bags with stock number, color, weight or other variable information. Bags are hand fed into the front of the machine and ejected on the side. The Model UC will print bag bottoms at speeds up to 30 bags per minute, depending on operator feed rate. The clutch-operated printing cylinder is triggered by a

microswitch to print on demand. The use of Kiwi inks ensures clean, sharp impressions on both non-porous and absorbent surfaces. The magnetic printing cylinder uses quick-change, curved metal type plates. Permanently mounted printing dies and/or channels for Kiwi Channelok type, baselock type and Magflex magnetic backed printing dies are available.

SPECIFICATIONS

PRODUCTION RATE:

Approx. 30 bags/min., hand feed

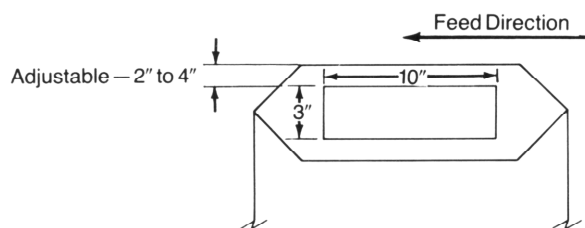

IMPRINT AREA:

10" long x 3" wide (max.)

PRINTING CYLINDER:

24" circumference x 3 3/4" wide magnetic. Single revolution, clutch operated

TYPE SYSTEMS:

Kiwi Channelok Type (Up to 3 Lines of 7/8" character height), Magflex magnetic-backed printing dies, baselock type and printing mats

INKING SYSTEM:

Two roller flexographic. Ink rollers run continuously

INKS:

Absorbent Surfaces: Kiwi #3 Ink and #8 Ink Conditioner. Non-absorbent Surfaces: Kiwi Flexo Inks

POWER REQUIREMENTS:

115V, 60 Hz, Single Phase

MOTOR:

1/4" HP, 115V, 60 Hz, T.E.

DIMENSIONS:

34" long x 31" wide x 26" high. Catcher approx. 26" long x 28" wide

FINISH:

Kiwi Blue

SHIPPING WEIGHT:

Approx. 450 lbs. (205 kg)

ON-LINE BAG PRINTING

MODEL 438TBF BAG PRINTER

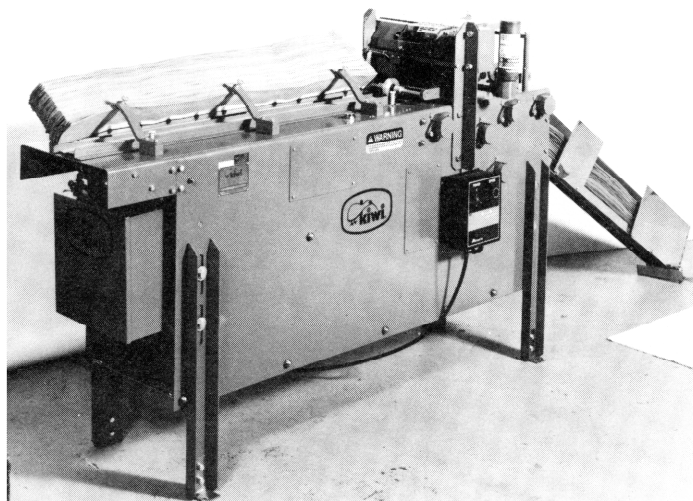

SPECIFICATIONS:

- PRODUCTION RATE: Variable, up to 20 bags per minute.
- VACUUM FEED.
- INKING SYSTEM: Two roller flexographic with pint bottle feed.
- INCLINED BAG CATCHER.
- MAGNETIC PRINTER CYLINDER: 12" circumference with 1-1/2" maximum print width.
- INPUT POWER REQUIREMENTS: 115VAC, 50/60 Hz, single phase.
- PRINTING TYPE: Kiwi channelok type, baselock type or printing mats on curved steel plates.
- SHIPPING WEIGHT: Approximately 900 lbs. (409 KG).
- FINISH: Kiwi blue.

The Kiwi Model 438TBF Bag Printer was designed to automatically feed and print variable information on 2-3/4" wide x 43-1/2" long kraft paper bags. A unique vacuum feed with three vacuum cups selects the bags from the bottom of a stack onto a belt conveyor. When leading edge of bag contacts an electric eye, the printing cylinder makes a single revolution printing the desired message on the bag. Imprint position is easily changed by adjustment of a time delay. These bags are used to package metal can lids for the beverage industry. Kiwi bag printers can be custom built to fit your application.

ON-LINE BAG PRINTING

FILLED BAG PRINTING - CONTACT AND NON-CONTACT

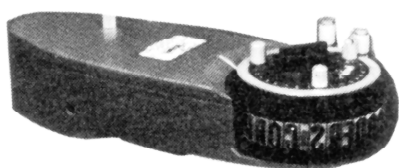

CONTACT CODERS

Kiwi Series 450 Coders (Bulletin 310) or Kiwi Model BIB Built-in Band Coders (Bulletin 158) are recommended for marking on the side or top of filled bags. The surface to be printed should be flat and rigid. An ideal location for a contact coder is a bag flattener, where it can be used for single message-line printing on the side of filled bags.

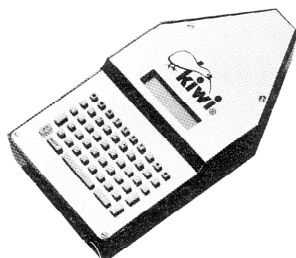

MATRIX SINGLE LINE NON-CONTACT INK JET PRINTER

The Matrix offers great versatility for printing on filled bags, since legible imprints are not dependent on whether the bag offers a firm surface for the imprint. Messages to be printed can be stored in the memory for future retrieval. Typical printed messages include time, date, consecutive count and graphics. Another application for the Matrix Printer is imprinting on paper tape prior to the bag stitching operation. (Request Bulletin 900).



KIWI CODERS CORPORATION

265 EAST MESSNER DRIVE - WHEELING, ILLINOIS 60090-6495 - U.S.A.
PHONE: 847/541-4511 FAX: 847/541-6332
www.kiwicoders.com e-mail: kiwicoders@aol.com